

MEMBRANE OVER WOOD

WITH A POURED GYPSUM UNDERLAYMENT

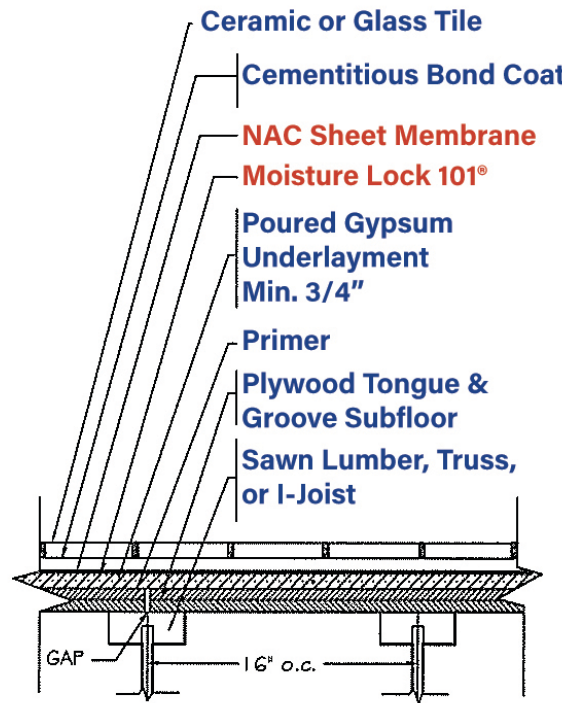

Use of a membrane is required for this installation.

All NAC sheet membranes (ECB®, ECB® 75, Strataflex®, SAM® 3 and Super SAM® 125) may be used in this type of application for wood substrates with a poured gypsum underlayment where the joist spacing is 16" on center.

Apply Moisture Lock 101 to fully cured gypsum underlayment.

All NAC sheet membrane systems require the use of the appropriate NAC Primer to ensure a permanent bond to the substrate.

For specification purposes, the NAC products used in this system are:

- NAC Sheet Membranes
- NAC Primer
- Moisture Lock 101

Visit NACproducts.com or call 800-633-4622 for more information.

Detail refers to F180 for wood substrates with a gypsum underlayment and joist spacing is 16" on center. See current edition of the TCNA Handbook for additional guidelines.



www.nacproducts.com | 3200 South Main Street, Akron, OH 44319

See product PDS, Install, and SDS sheets for complete instructions and safety requirements.

©2020 NAC Products, Inc. All Rights Reserved Rev. 10/20 #F180-NAC