

# SHOWER WATERPROOFING

## SUBSEAL® LIQUID MEMBRANE

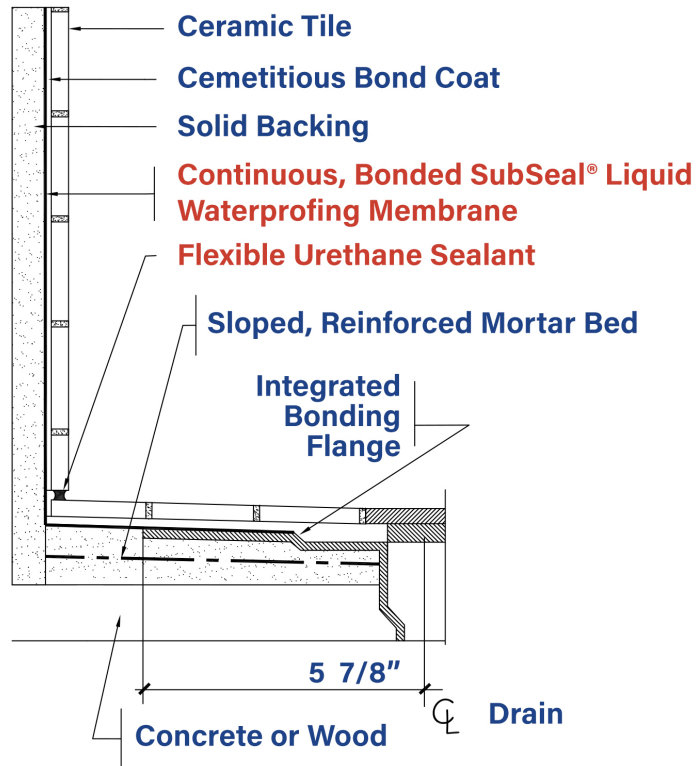

Shower receptors, curbs, seats, etc., must be properly waterproofed and installed to avoid water damage to adjacent building materials.

For specification purposes, the NAC products used in this system are:

- SubSeal Liquid Membrane
- Strataflex Sheet Membrane (If Required)
- NAC Primer
- NAC Approved Urethane Sealant

Visit [NACproducts.com](http://NACproducts.com) or call 800-633-4622 for more information.

Detail refers to B422 for shower receptors. See current edition of the TCNA Handbook for additional guidelines.



[www.nacproducts.com](http://www.nacproducts.com) | 3200 South Main Street, Akron, OH 44319

See product PDS, Install, and SDS sheets for complete instructions and safety requirements.  
©2020 NAC Products, Inc. All Rights Reserved Rev. 10/20 #B422-NAC